

For Lease

# BAYSIDE BUSINESS PARK

Office Space from ±1,200 - ±12,386 SF | Industrial Units from ±2,200 - ±10,285 SF

1120, 1124, & 1128 Bay Blvd., Chula Vista, CA 91911



## Property Details

- +/- 76,000 SF Industrial Business Park
- 1,200 - 1,900 SF Office Suites Available
- 3/1000 SF Parking Ratio
- Sprinklered
- Beautiful View of San Diego Bay and Coronado
- Great Access to I-5 Freeway and Close to Downtown
- 3 Phase Power Available to All Buildings
- Common Dockwell and Ground Level Doors
- Perfect for Manufacturing, Warehouse, Distribution & Wholesale Uses



**Tracy Charles Clark**  
Senior Vice President  
858.458.3339  
tclark@voitco.com  
Lic. #00641800

**Kimberly C. Clark, J.D.**  
Associate  
858.458.3343  
kclark@voitco.com  
Lic. #01439305

For Lease

# BAYSIDE BUSINESS PARK

Office Space from 1,200 - 12,386 SF | Industrial Units from 2,200 - 10,285 SF

1120, 1124, & 1128 Bay Blvd., Chula Vista, CA 91911



**Tracy Charles Clark**  
Senior Vice President  
858.458.3339  
tclark@voitco.com  
Lic. #00641800

**Kimberly Channele Clark, J.D.**  
Associate  
858.458.3343  
kclark@voitco.com  
Lic. #01439305

The information contained herein has been obtained from sources we deem reliable. While we have no reason to doubt its accuracy, we do not guarantee it.  
©2012 Voit Real Estate Services, Inc. All Rights Reserved. Real People. Real Solutions.® is a registered trademark of Voit Real Estate Services.



**Voit**  
REAL ESTATE SERVICES

For Lease

# BAYSIDE BUSINESS PARK

Office Space from 1,200 - 12,386 SF | Industrial Units from 2,200 - 10,285 SF

1120, 1124, & 1128 Bay Blvd., Chula Vista, CA 91911

## Floor Plan | 1124 Bay Blvd.

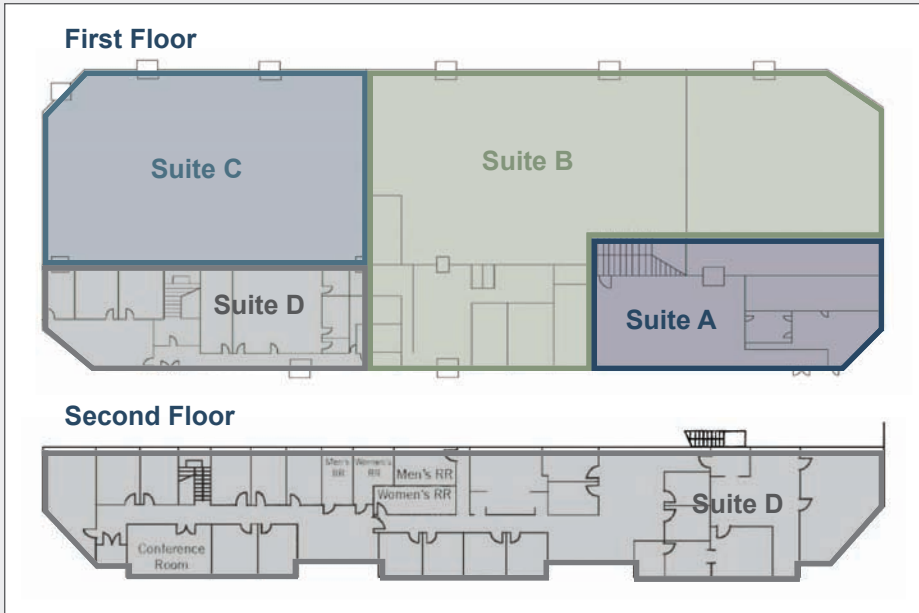

### 1124 Bay Blvd Availability

Suite	Office SF	Warehouse SF	Total SF	Truck Doors	Avail.
A	1,900	500	2,400	0	Now
C	0	7,079	7,079	1 Dock, 1 Grade Level	Now
D	12,386	0	12,386	0	Now

## Site Plan

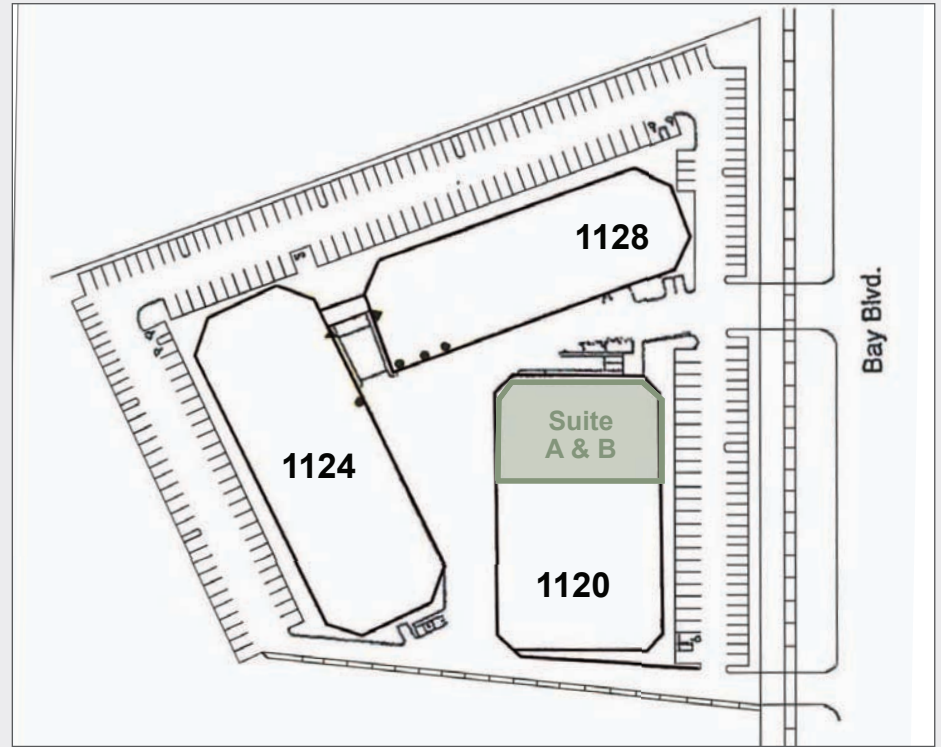

### 1120 Bay Blvd Availability

Building	Suite	Total SF	Truck Doors	Avail.
1120	A & B	8,300	1 Dock, 2 Grade Level	Avail. in 30 days

**Tracy Charles Clark**  
Senior Vice President  
858.458.3339  
tclark@voitco.com  
Lic. #00641800

**Kimberly Channele Clark, J.D.**  
Associate  
858.458.3343  
kclark@voitco.com  
Lic. #01439305

The information contained herein has been obtained from sources we deem reliable. While we have no reason to doubt its accuracy, we do not guarantee it. ©2012 Voit Real Estate Services, Inc. All Rights Reserved. Real People. Real Solutions.® is a registered trademark of Voit Real Estate Services.



**Voit**  
REAL ESTATE SERVICES